

Product Overview

GoLift Scale



GO-LIFT-SCALE-ASSY
Class 3 Scale: GO-LIFT-SCALE-EU-ASSY



GoLift Scale

The GoLift Scale provides an integrated method for the patient lift system to measure a patient's weight. It is a modular component that is mounted between the bottom of the strap and the carry bar. It features the Amico quick release system so that it can be removed and attached without the use of tools, allowing it to be moved around from room to room as required.

NOTE: Scale is not compatible with the fixed carry bar systems.

NOTE: Refer to the manual for operating instructions.

Models

	GO-LIFT-SCALE-ASSY	Class 3 Scale GO-LIFT-SCALE-EU-ASSY
Maximum Capacity	454 kg (1000 lbs)	400 kg (880 lbs)
Display Resolution	e = 0.1 kg	e = 0.2 kg
Accuracy	0.1% ± 1 digit of displayed resolution	0 - 100 kg: 0.1 kg 100 - 400 kg: 0.2 kg

NOTE: Class 3 Scale is only in kilograms.

Each scale comes with

- Weight module
- 9V battery
- Declaration of conformity
- Calibration certificate

Dimensions

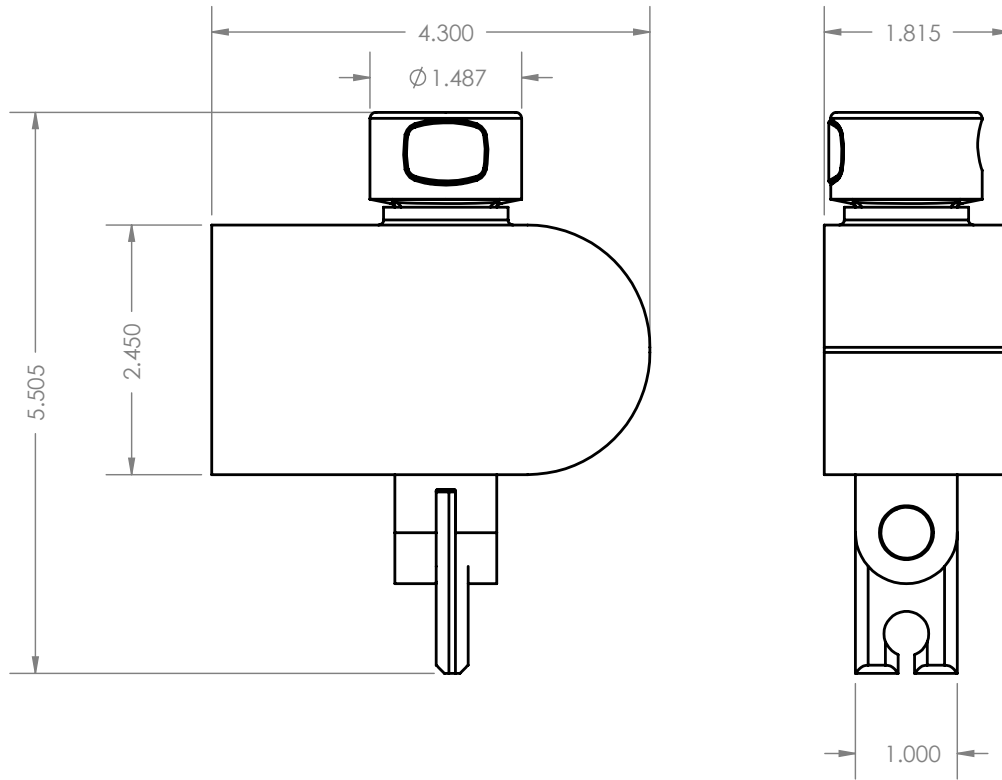

*Dimensions are shown in inches