

Duo Med Ambient LED Light

Tunable

Description:

The Duo Med Tunable White LED Light enhances patient rooms with customizable ambient lighting, tunable from 2700K to 6500K. Fully enclosed LEDs ensure patient safety, while advanced optics deliver glare-free, uniform illumination. Designed to mimic natural daylight, it creates a soothing, adjustable environment that promotes patient comfort and supports clinical care.

Features:

- Hospital grade material and finish
- Acrylic diffuser
- Ambient lights
- Seam welded enclosure
- Long lasting LEDs
- Options for triple gasketing and overlapping door available



Construction Material:

Housing: 20ga CRS, single piece, seam-welded construction.

Finish: White urethane powder coat finish – hospital grade material and finish.

Lens: IP65 rated fully enclosed CRS cover, with acrylic diffuser.

Drivers: High power factor constant current, 0.97 pf @ 120 V (Class 2, Class II).

Tunable Driver: Bridgelux vesta with the 0-10 V control module.

Light Source: Samsung LEDs mounted on Aluminum Core PCB.

Specifications:

Color Tuning: 2700K - 6500K Tunable White Ambient.

Voltage: 120 - 277 Volts.

Standard Wattage: Ambient: 30 W, Total Pair: 60 W.

Standard Light Output: Ambient: 3,185 lms, Total Pair: 6,370 lms.

Dimming Options: 0 - 10 Volts, Standard 1% dimming; DALI options available.

Color Quality: Standard 80 CRI, contact factory for 90 CRI option.

Standard Color Temperature: 3000K, 3500K, 4000K (contact factory for additional options).

Life of LEDs: L70 > 100,000 hours.

Listings: Certified to UL standards by ETL. Conforms to CSA standards as per ETL testing.

Warranty: Limited five (5) year warranty.

Duo Med Ambient LED Light

Tunable

Ordering Guide:

L - SDM - H - - - TWA - - - - -

└─ Voltage
└─ Function
└─ Tunable White
└─ Color Temperature
└─ CRI
└─ Mounting
└─ Switching
└─ Options

For Example: L-SDM-H-120-A100-TWA30-A-G-LMD-OD

Solar Series Duo Med Ambient LED Light, 120V, Ambient (standard lms), Tunable White Ambient, 3000 Kelvin, 80 CRI, Grid Mount, LightMaster with dimming, Overlapping Door

Ordering Information:

Series	Voltage*	Functions	Tunable White**	Color Temperature*** (for other functions)	CRI	Mounting	Switching	Options
L-SDM-H	120	A100 Ambient only (standard lms)	TWA Tunable White Ambient	30 3000K	A 80 CRI	F Flange mount	000 No switch (provided by others)	00 No options, Standard Inset Door
	277	A200 Ambient only (high lms)	**Contact factory for other functions as tunable white	35 3500K	B 90 CRI	G Grid mount	LVC Low voltage controller	OD Overlapping Door
*Consult factory for 347 V requirement		XYZ Custom lumens		40 4000K			LVD Low voltage controller with dimming	IT Inset Door, Triple Gasketing
				XX Custom Temperature			LMS LightMaster without dimming	OT Overlapping Door, Triple Gasketing
				***Consult factory for additional options			LMD LightMaster with dimming	
							DAL Digital Addressable Lighting Interface Driver (DALI)	

Standard Output:

(per fixture)

Ambient = 3,185 lms, 30 W, 106 lms/W

High Output:

(per fixture)

Ambient = 4,118 lms, 39 W, 106 lms/W

Solar Series

Duo Med Ambient LED Light

Tunable

Dimensions:

Inset Door:

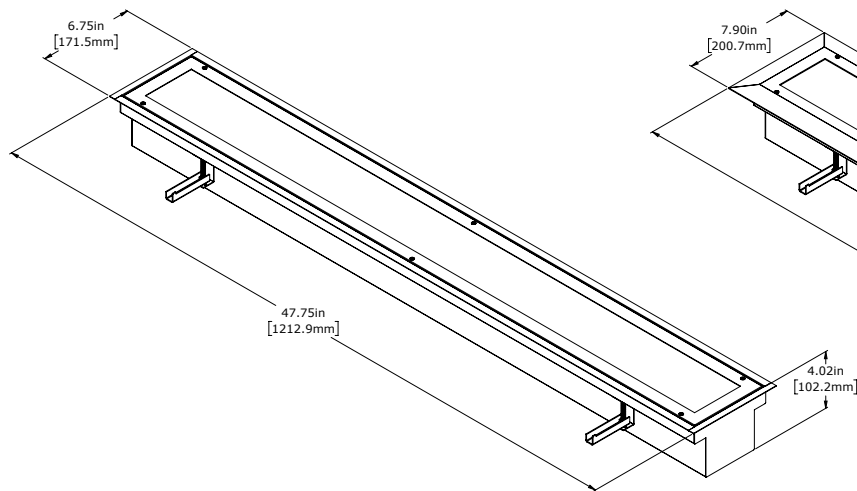

Overlapping Door:

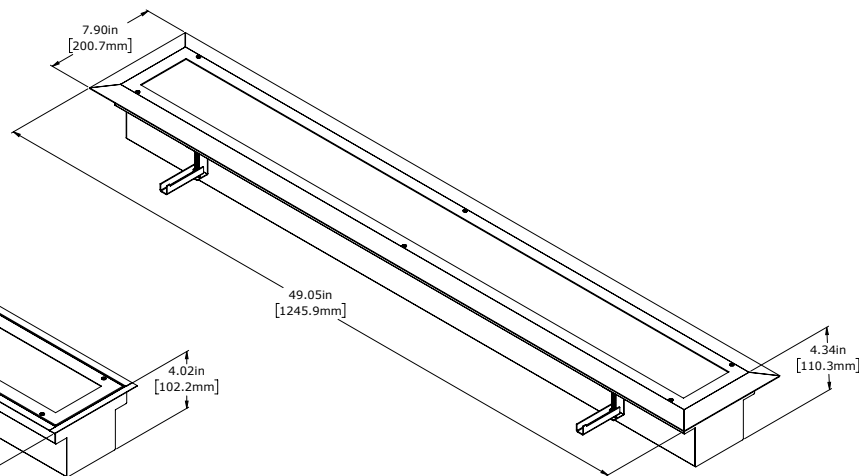

Distance Between Swing Arm and Flange:

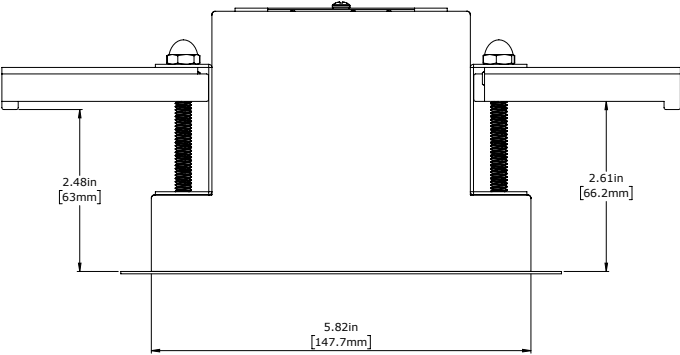

Ceiling Cutout Dimensions:

*Per Single Duo Med Fixture

Ceiling Cutout Length (inches)	Ceiling Cutout Width (inches)
47.25	6.125

*Ceiling Cutout should be accurate within 1/16 of an inch