

Solar Series - MRI

LP6 - Low Profile 6" Can Light

3500K/4000K Selectable

MRI Compatible

Product Description

The LP6 light fixture is designed for MRI suite applications and has a non-ferrous assembly which can be mounted within the MRI room. The LP6 is supplied with a junction box and requires no additional housing or can for low-profile recessed applications. It can be mounted directly into a dry wall ceiling or a suspended ceiling grid using the optional Suspended Ceiling Mounting Bracket Assembly. Contains no on-board electronics therefore will not interfere with MRI imaging. Certified to meet MRI vendor EMI requirements. MRI applications require EMI free emissions for specific frequency bands. All drive circuitry employs linear regulation and no pulse width modulation (PWM*).

Performance Summary

- Initial Delivered Lumens: 1400 lm
- Input Power: 17 watts
- CCT: 3500K/4000K Selectable
- Limited Warranty: 5 years
- Lifetime: Designed to last 50,000 hours
- Dimming: Linear

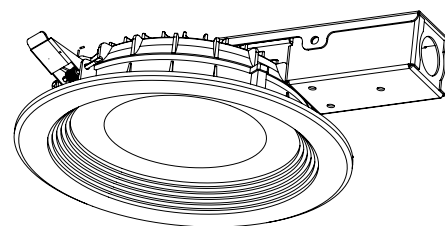

LP6 Low Profile

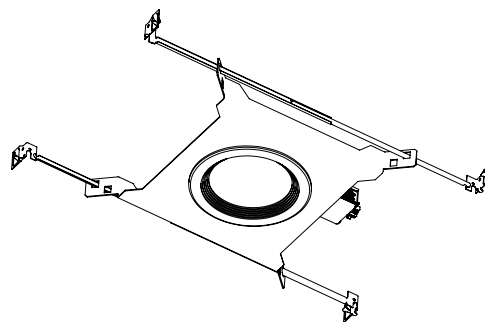

Suspended Ceiling Mounting Bracket Assembly

Mechanical

	Minimum	Typical	Maximum	Units
Package	-	Self-Contained	-	ANSI Std.
Electrical Connection	-	Junction Box	-	ANSI Std.
Fixture Weight	-	1.1	-	lbs

Installation

	Minimum	Typical	Maximum	Units
Ceiling Thickness	-	-	0.625	inches
Ceiling Cut-out	-	-	6.5	inches

Electrical

	Minimum	Typical	Maximum	Units
Input Voltage	-	24	-	Vdc
Input Current	-	700	-	mA
Input Power	-	17	-	W
BTU	-	58.24	-	BTU/hr

Environmental

	Minimum	Typical	Maximum	Units
Storage Temperature	-40	25	85	C
Operating Temperature	-20	25	-	C
Humidity	5	-	95	%
Lifespan	50000	-	-	Hours
Warranty	-	3	-	Years

Compliance

	Minimum	Typical	Maximum	Units
IP	-	20	-	Dry Location
Regulatory	-	Listed	-	UL 2108 CSA 22.2#250.0
RoHS	-	Compliant	-	2011/65/EU 2015/863

Ordering Information

Part Number	Description
1-07-000571	LP6 Low Profile - Ethernet Wiring Assembly
1-07-000572	LP6 Low Profile - 24Vdc Wiring Assembly
1-07-000594	Suspended Ceiling Mounting Bracket Assembly - LP6 Ethernet with Spreader
1-07-000595	Suspended Ceiling Mounting Bracket Assembly - LP6 DC with Spreader

Installation Notes

A RF Filter is required for proper operation in the MRI suite

A Power Supply is required for proper operation in the MRI suite

*PWM is known to cause image artifacts, audible noise and light flicker

Dimensions

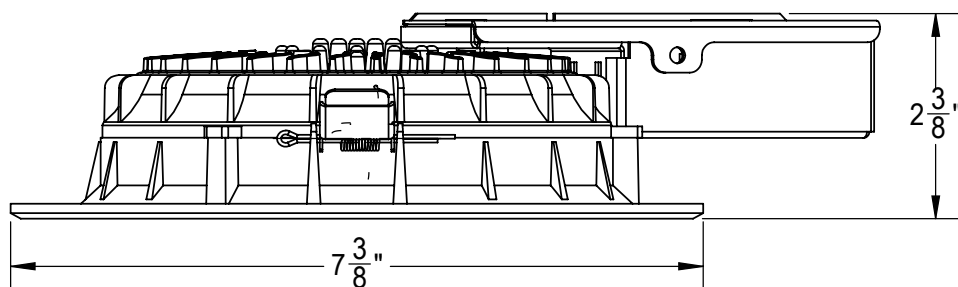

Mounting Option - Suspended Ceiling Mounting Bracket Assembly*

The LP6 can be installed in a suspended ceiling grid using the optional Suspended Ceiling Mounting Bracket Assembly. Ensure the existing grid is capable of supporting the weight of the luminaire.

- Easy and versatile installation.
- Can be installed directly to an existing Suspended Ceiling Grid.
- Requires minimal tools and construction making it a quick and easy install in the MRI room.

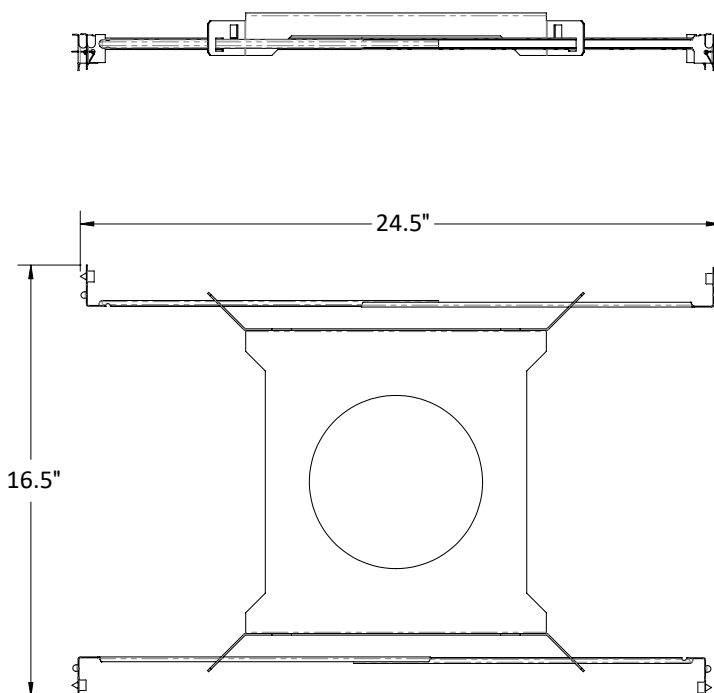

3500K Photometric Data and IES Distribution

	Minimum	Typical	Maximum	Units
Luminous Flux	-	1416	-	lm
CCT	3300	3500	3700	k
CRI	90	-	-	-
Chromaticity (u')	-	0.241	-	-
Chromaticity (v')	-	0.511	-	-
Efficacy (DC)	-	85	-	lm/W

Spectral Data Over Visible Wavelength - 3500K

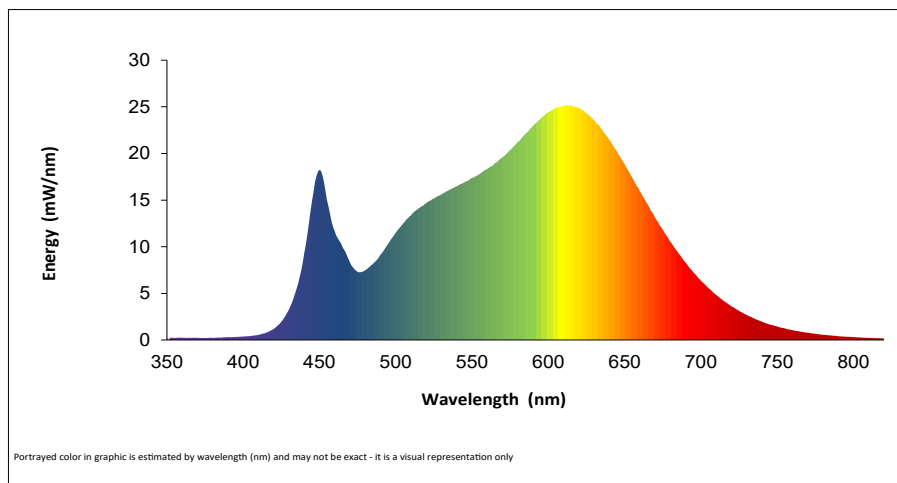

Polar Plot - 3500K

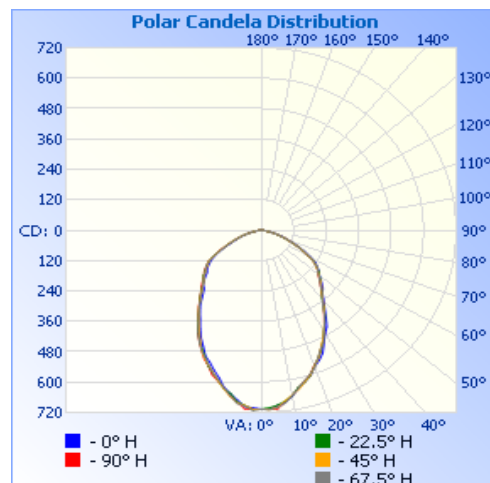

4000K Photometric Data and IES Distribution

	Minimum	Typical	Maximum	Units
Luminous Flux	-	1453	-	lm
CCT	3800	4000	4200	k
CRI	90	-	-	-
Chromaticity (u')	-	0.221	-	-
Chromaticity (v')	-	0.511	-	-
Efficacy (DC)	-	85	-	lm/W

Spectral Data Over Visible Wavelength - 4000K

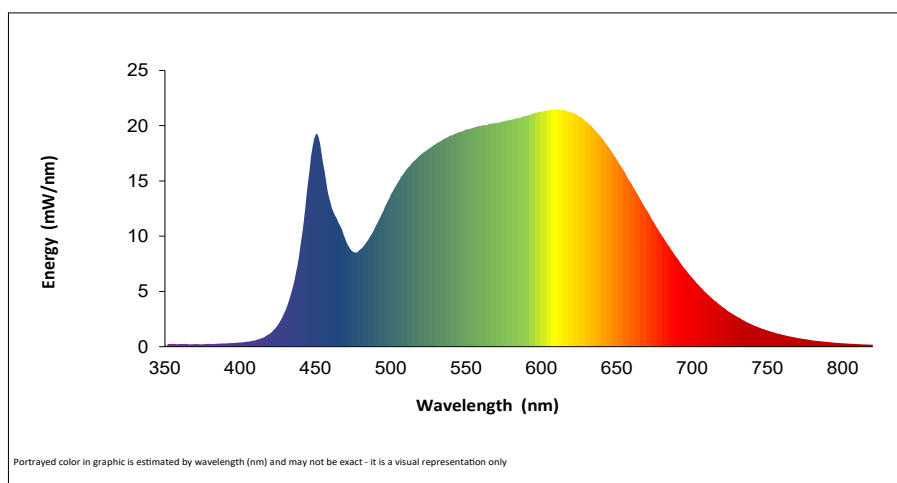

Polar Plot - 4000K

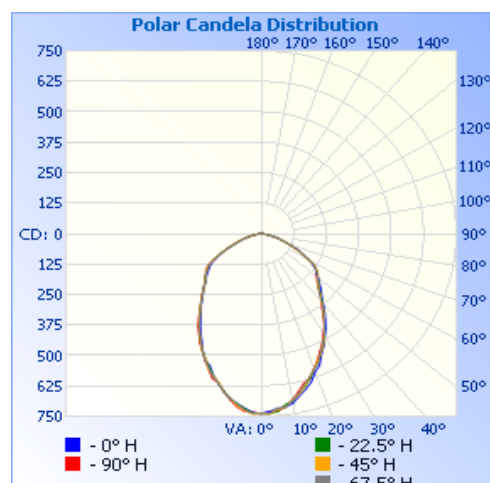

*For informational purposes only. Content subject to change.