

Light-duty Monitor Arm

Quick Installation and Adjustment Instructions



Medical Facility Responsibility



WARNING: It is the responsibility of the end user to ensure all aspects of the installation are covered by following the full manual at: <https://www.amico.com/sites/default/files/products/amico-aa-lma-light-duty-monitor-arm-manual.pdf>

LMA Monitor Arm

1. **Monitor Mounting Adapter**
VESA LCD mount
2. **Monitor Head - Rotation**
Monitor rotation adjustment
3. **Counter Balance**
Used to adjust for zero movement
4. **Arm Rotation Adjustment**
Used to adjust ease of rotation
5. **Extension Arm ***
LMA extension arm shown
6. **Extension Arm Rotation Adjustment**
Used to adjust ease of rotation
7. **Mounting Adapter**
MON adapter shown for MRS rail

* If requested

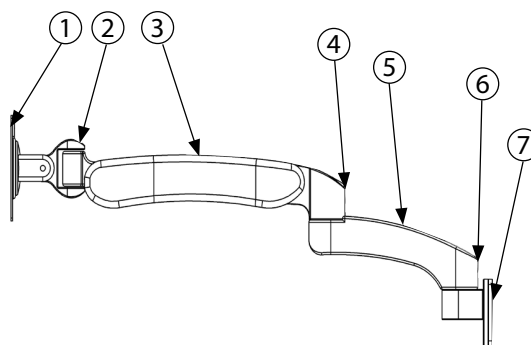

Installation Tools



Quick Setup

Mounting to MRS (Monitor Rail System)

1. Assemble LMA to X-LMA-(MON/MON-B)-ADA by placing LMA onto X-LMA-(MON/MON-B)-ADA and securing with the SCREW through WASHER, X-LMA-(MON/MON-B)-ADA, LMA, and into CAP, using #3 Phillips Head screwdriver (as shown in **Figure 1** on the left below).
2. Slide X-LMA-(MON/MON-B)-ADA into the MRS RAIL (as shown in **Figure 1** on the right below).
3. Once the arm is positioned at the desired height, tighten 2x of the parts labeled H-SSCP-1420-05 in **Figure 1** below with a 1/8" (3.2 mm) Hex key.

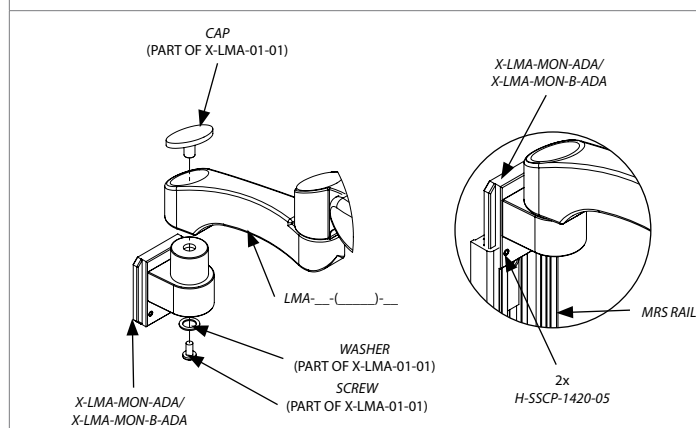

Figure 1

Mounting to VRS (Vertical Rail System)

1. Remove the top X-GTA-KNOB/X-GTA-KNOB-B and the attached HR-CONV-PIN. (**Figure 2**)
2. Place LMA-__-(____)-__ onto X-LMA-VRS-ADA/X-LMA-VRS-B-ADA and secure by inserting SCREW (part of X-LMA-01-01) through WASHER (part of X-LMA-01-01), X-LMA-VRS-ADA/X-LMA-VRS-B-ADA, LMA-__-(____)-__, and into CAP (part of X-LMA-01-01). (**Figure 2**)
3. Replace the TOP HR-CONV-PIN and X-GTA-KNOB/X-GTA-KNOB-B. (**Figure 2**)
4. Turn 2x X-GTA-KNOB/X-GTA-KNOB-B to loosen 2x HR-CONV-PIN. Tilt and guide the 2x HR-CONV-PIN into the opening of the VRS RAIL. (**Figure 3**)
5. Ensure the flange on the X-SSM-VERT-ADA is properly aligned with the VRS RAIL. Position to desired height before tightening 2x X-GTA-KNOB/X-GTA-KNOB-B. (**Figure 3**)
6. Lock the 2x X-GTA-KNOB/X-GTA-KNOB-B with 2x H-1420-LNUT-NYL using a 1/2" (12.7 mm) socket wrench and cover with 2x H-CAP-14-B. (**Figure 3**)

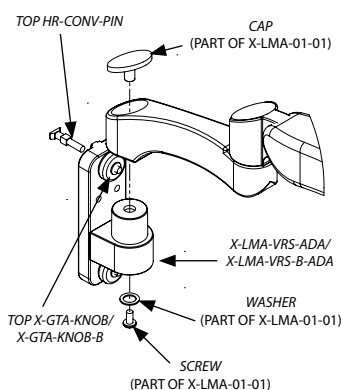

Figure 2

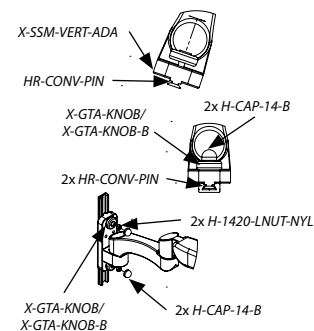

Figure 3

Light-duty Monitor Arm

Quick Installation and Adjustment Instructions



Quick Adjustment Reference

Rotation (LMA Side to Side)

To adjust the tension on the movement of the arm, tighten or loosen the **SCREW** in the appropriate joints as shown in the detailed view below using a 2.5 mm Hex key.

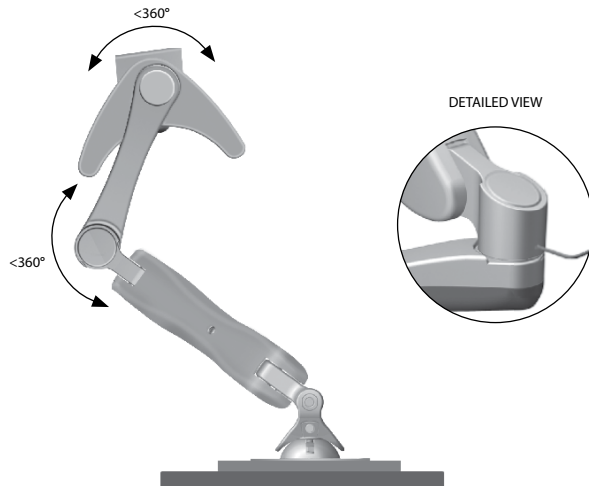

Figure 4

Head Tilt

Tighten or loosen the appropriate **SCREW** as shown in **Figure 5** to adjust the monitor's position accordingly. For swivelling, use a 5 mm Hex key. For tilting, use a 6 mm Hex key.

WARNING: Do not loosen the **TOP SCREW**. Doing so may cause the head assembly to fall off.

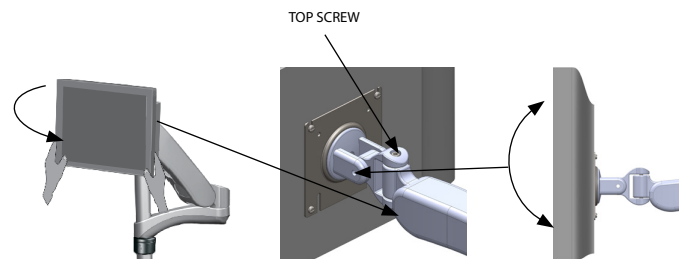

Figure 5

Counter Balance

If the monitor does not hold its position or is too resistant, adjust the **SCREW** clockwise for heavier loads and counter-clockwise for lighter loads for counter-balance as shown in the **DETAILED VIEW** below in **Figure 6**, with a 5 mm Hex key.

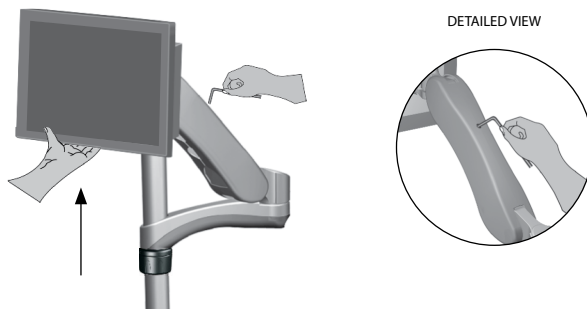

Figure 6

Cable Management

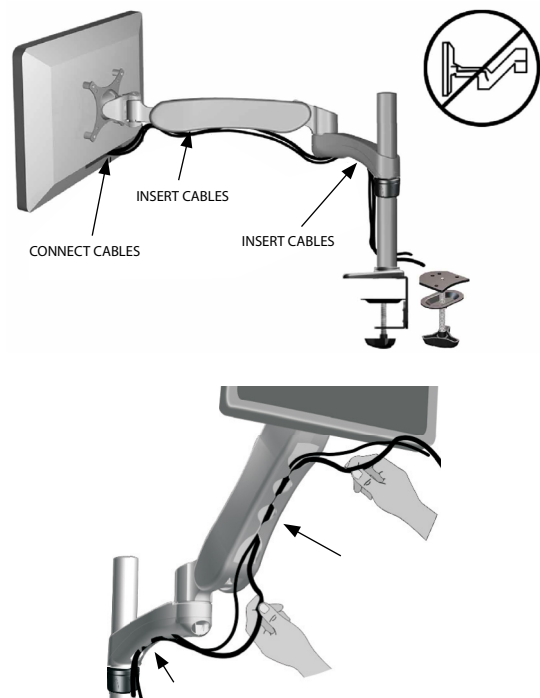

Figure 7