

# Installation Instructions

## Barcode Dock Mounts



# Preface

## Important, Please Read Carefully

Thank you for your purchase with Amico Accessories Inc.

This unit is designed for long lasting performance, providing the end user complies with assembly and maintenance procedures. This Instruction Manual is your guide to ensure that you get the best performance out of the equipment. Amico Accessories Inc. is not responsible for any damage as a result of (but not limited to) abuse and other problems that may be a direct or indirect result of failure to comply with the instructions provided in this manual.

Please note these key words and symbols:



**WARNING:** Steps where extra care should be taken to prevent injuries and damage.



**NOTE:** Steps that point out helpful information.

## Medical Facility Responsibilities

Preventive maintenance checks must be performed regularly to maintain the quality and performance of this product. Any parts that may be broken, missing, worn, distorted, or contaminated in any way should not be used and all affected parts should be replaced immediately. Should the necessity of any repair be suspected; please contact your local distributor.

# Table of Contents

<b>Section 1: Product Specifications</b>	<b>3-5</b>
Features	3
Specifications	3
Technical Drawings	3-4
Product Classification	5
<b>Section 2: Installation Preparation</b>	<b>6</b>
Installation, Tools and, Part Requirements	6
<b>Section 3: Device Installation</b>	<b>7-10</b>
Installation to Device	7
Parts Legend	8
Barcode Scanner Compatibility to BARCDHLD2 by Make and Model	9-10
<b>Section 4: Installation on Mounting Platform</b>	<b>11-18</b>
Mounting Preparation	11
Mounting on the MRS	11
Mounting on the VRS/Dovetail/Ohmeda Rail	12
Mounting on the ARS	13
Mounting on FRS and LRS	14
Mounting on the DIN Rail	15
Mounting on Hill-Rom/HSI Rail Systems	16
Mounting on 1.25" Diameter Post	17
Mounting to LCD	18
<b>Section 5: Adjustments</b>	<b>19</b>
Adjustment to LCD BARCODE SCANNER HOLDER	19
<b>Section 6: Maintenance and Troubleshooting</b>	<b>20</b>
Troubleshooting Guide	20
Preventative Maintenance	20
<b>Section 7: Cleaning</b>	<b>21</b>
<b>Warranty</b>	<b>22</b>

# Section 1: Product Specifications

## Features

- Rail mounting or LCD VESA plate mounting options available
- Compatible with a variety of barcode scanners and charger bases
- Supported barcode scanner bases can be mounted in different orientations
- Expansion plate for additional width support included
- 2 cradle styles compatible: upright (vertical) or horizontal

## Specifications

- 3.2" L x 4.2" W
- 8.15" L x 4.2" W (optional expansion plate)
- Slots for use with 4 x 20 mm MACHINE SCREWS

## Technical Drawings

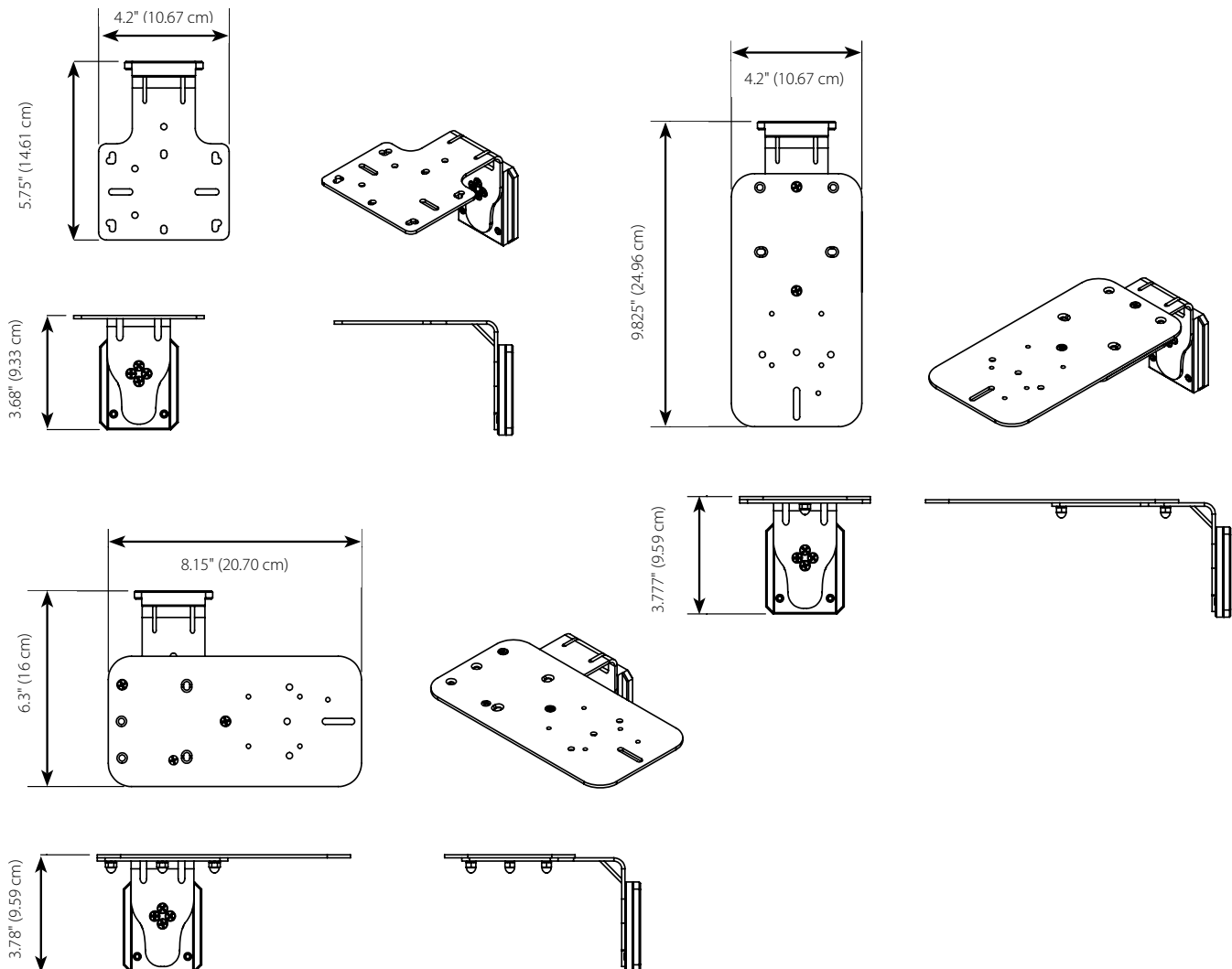

# Section 1: Product Specifications

## Technical Drawings

BARCDHLD2-LCD  
 \*no expansion plate

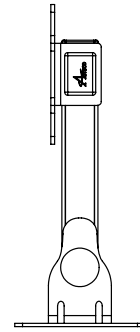
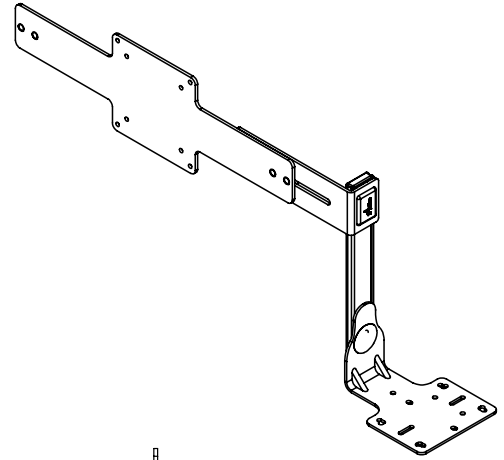
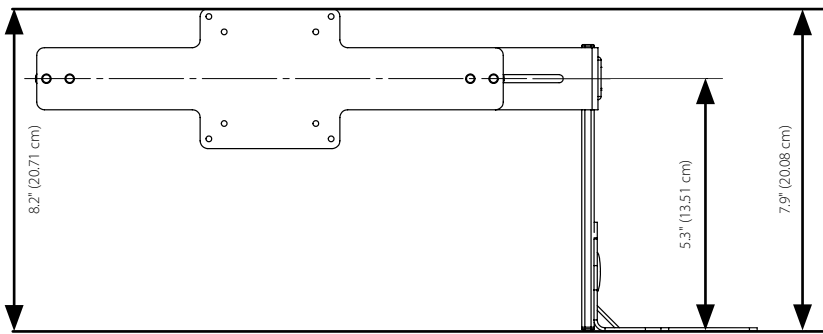
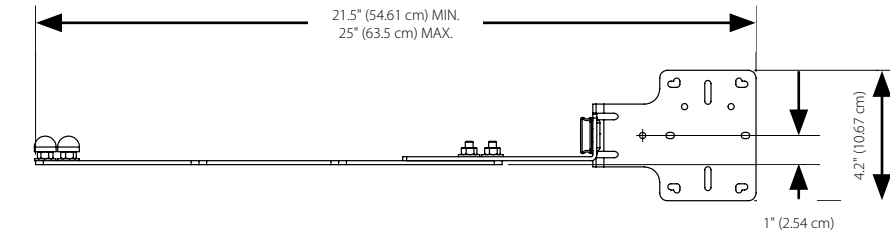

BARCDHLD2-LCD  
 \*with expansion plate

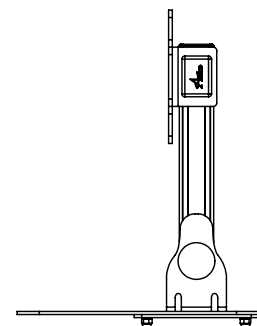
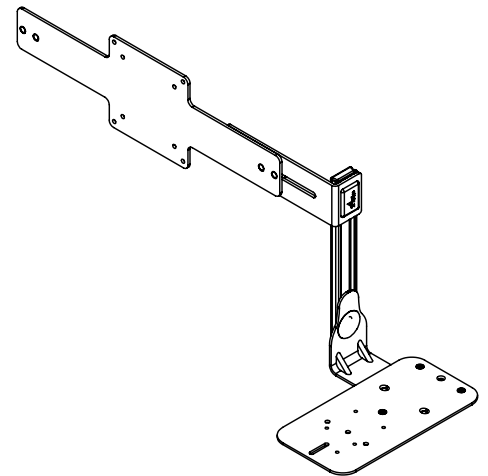
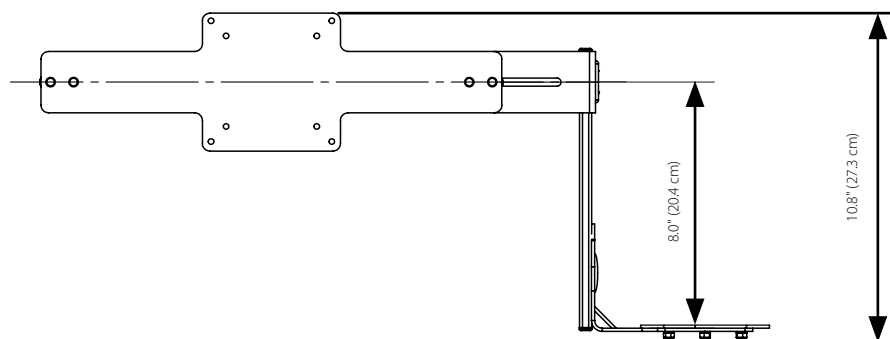
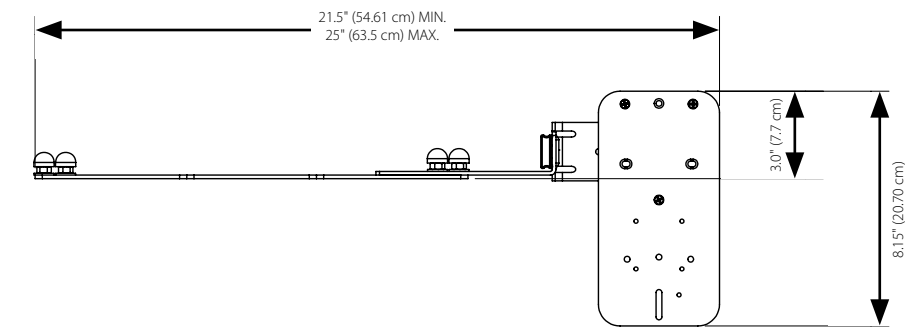

# Section 1: Product Specifications

## Product Classification

**BARCDHLD2-X**  
(Replace the X with desired option)

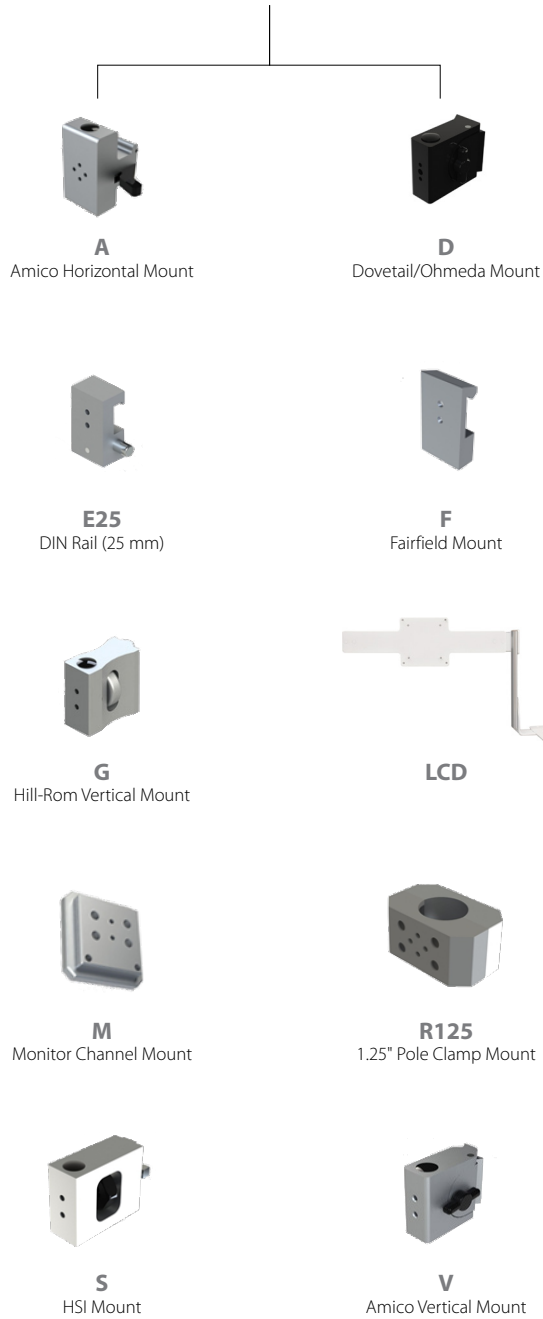

# Section 2: Installation Preparation

## Installation, Tools and, Part Requirements

A hex key (or Allen key) is required for models *BARCDHLD2-M* and *BARCDHLD2-LCD*. Please confirm your product model before proceeding.



#2 Philips Screwdriver



Hex Key 1/8

**NOTE:** Tools for installation are not provided by Amico Accessories Inc.

## Installation Reference



BARCDHLD2-V



BARCDHLD2-LCD



Expansion Plate and Hardware Kit Envelop

## Pre-Installation Information (PLEASE READ CAREFULLY BEFORE STARTING)

- WARNING:** VERIFY THE WEIGHT OF THE DEVICE TO BE MOUNTED. THIS PRODUCT IS RATED AT 5 LBS (2.3 KG) TOTAL LOAD.
- WARNING:** VERIFY THAT RAILS HAVE BEEN INSTALLED IN ACCORDANCE WITH AMICO RAIL INSTALLATION INSTRUCTIONS. RAIL FAILURE WITH DEVICES MOUNTED CAN CAUSE SERIOUS INJURY AND EQUIPMENT DAMAGE.
- WARNING:** IT SHALL BE THE RESPONSIBILITY OF THE HOSPITAL, ITS CONSULTANTS AND/OR CONTRACTORS TO DETERMINE IF THE MOUNTING SURFACE IS ADEQUATE TO SAFELY MOUNT THE SPECIFIC INSTRUMENT. THIS INCLUDES THE SELECTION OF APPROPRIATE FASTENERS AND PROPER INSTALLATION INDEPENDENT OF WHAT IS SUPPLIED WITH YOUR PRODUCT. SEE RAIL INSTRUCTIONS FOR SPECIFIC WALL CHANNEL GUIDELINE INFORMATION.

## Pre-Installation Instructions

- Determine the preferred orientation of the barcode charging base and refer to the below illustrations for mounting. Note the illustrations shown may not portray the configuration purchased. Use this guide as a reference to pair hardware and mounting hole pattern with respective barcode scanner base (not provided).

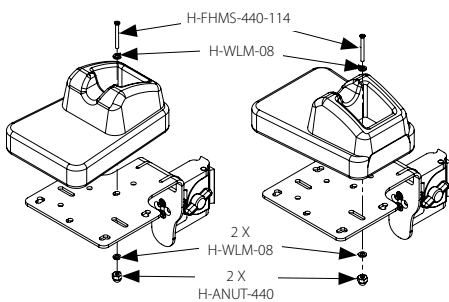

BARCODE CHARGING BASE WITH ONE HOLE, SUCH AS HONEYWELL 2020 FOR BARCODE SCANNERS: 3820, 4620, 4820, OR 5620

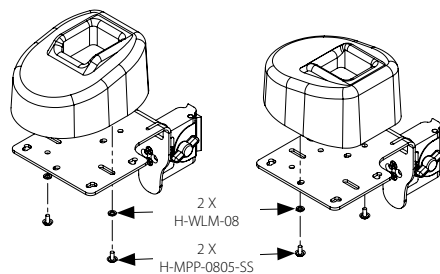

BARCODE CHARGING BASE WITH TWO HOLES, SUCH AS HONEYWELL CCB01-010BT FOR THE HONEYWELL XENON 1900, 1910, 1902, 1912

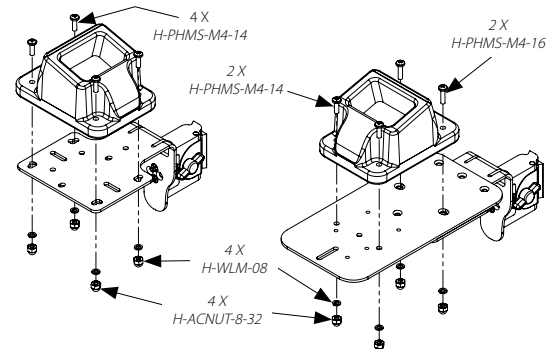

BARCODE CHARGING BASE WITH FOUR HOLES, SUCH AS CODE READER CRA-A101 OR CRA-A104 FOR CR2600

# Section 3: Device Installation

## Installation to Device

1. Before mounting the barcode scanner onto the mounting plate, determine the mounting pattern on the barcode scanner base. If the barcode scanner base is too large to mount onto *BARCODE SCANNER HOLDER*, proceed to Step 2 for installation of secondary plate.
2. If the secondary *EXTENSION PLATE* is required, determine the preferred orientation (refer to Section 2: Pre-Installation Instructions) and secure by inserting 2 x or 3 x *H-FHPMS-832-12* through *EXTENSION PLATE*, *BARCODE SCANNER HOLDER*, 2 x or 3 x *STEEL LOCK WASHER*, 2 x or 3 x *ACORN NUT*, ensuring that the mounting screws do not interfere with the mounting pattern of the barcode scanner base.

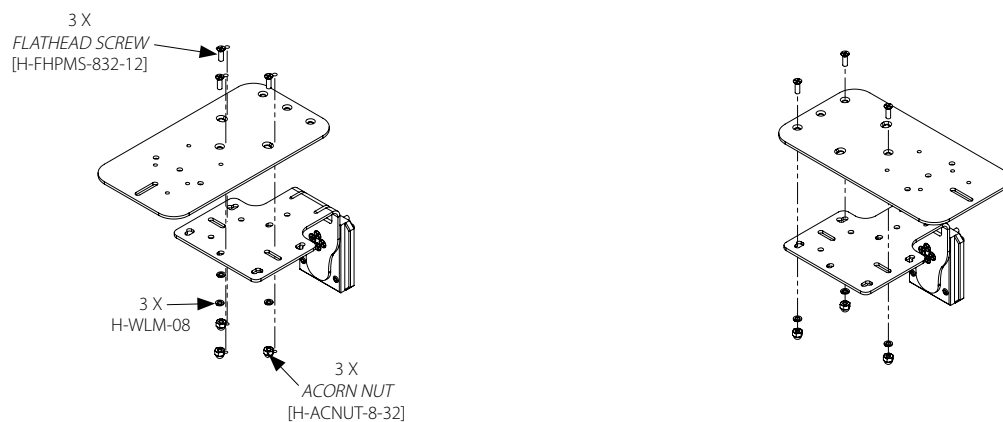
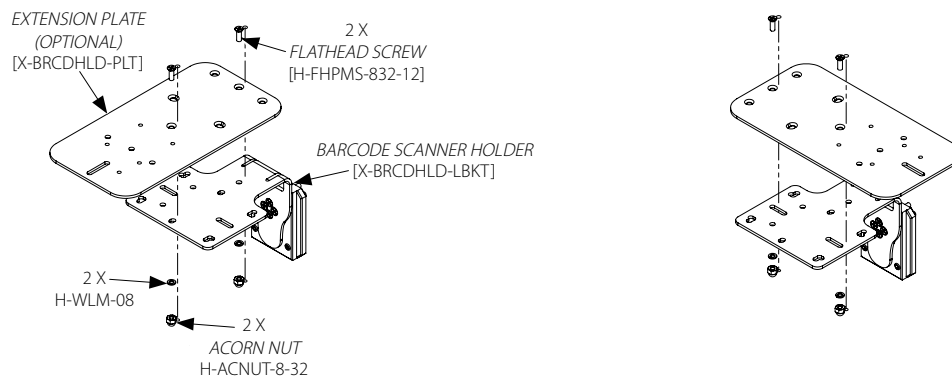



# Section 3: Device Installation

## Parts Legend

 **NOTE:** Please note part descriptions provided below.

Manufacturer Part Number	Part Description
X-BRCDHLD-LBKT	BARCODE SCANNER HOLDER
X-BRCDHLD-PLT	EXTENSION PLATE (OPTIONAL)
X-FHPMS-832-12	FLATHEAD SCREW
H-WLM-08	STEEL LOCK WASHER
H-ACNUT-8-32	ACORN NUT
H-CAP-14-W	HEX BOLT NUT AND CAP
H-1420-LNUT-NYL	NYLON LOCK NUT
X-HBLOCK-ARM	LEVER ARM
H-HNUT-1420	HEX NUT
X-MON-SHELF-ARM	LCD SHELF ARM
X-PC-125-1-8-32	FRONT HALF POLE CLAMP
X-PC-125-2-8-32	BACK HALF POLE CLAMP
H-HSCS-1420-58	HEX SOCKET CAP SCREW
X-MON-CLAMP-A	HORIZONTAL TRACK ADAPTER
FTA-8-32 ADAPTER	FAIRFIELD TRACK ADAPTER
ETA ADAPTER (ETA-25-8-32)	DIN RAIL ADAPTER
H-HSSS-71620-38	ALLOY HEX SET SCREW
STA-8-32	HSI TRACK ADAPTER
GTA-8-32	HILL-ROM TRACK ADAPTER
X-HSI-KNOB	HSI KNOB
H-HR-CONV-PIN-2	HILL-ROM RAIL ADAPTER PIN
H-STDF-38-14-10	NYLON STANDOFF
X-GTA-KNOB	HILL-ROM TRACK ADAPTER KNOB
W-X-BALL-375-NY	NYLON BALL BEARINGS
H-PHMS-M4-16	16 mm PANHEAD SCREW
X-MON-HDL-BODY	MONITOR HANDLE BODY
H-MPR-M4-20	20 mm MACHINE SCREW
H-PHMS-M4-12	12 mm PANHEAD SCREW
H-PHMS-M3-10	10 mm LONG PANHEAD SCREW
H-WASH-M3-6	WASHER FOR SCREWS
H-WLS-03	STEEL LOCK WASHER
H-ACNUT-M3	ACORN NUT
H-PHMS-M3-8-P	8 mm LONG PANHEAD SCREW WITH PATCH

# Section 3: Device Installation

## Barcode Scanner Compatibility to BARCDHLD2 by Make and Model

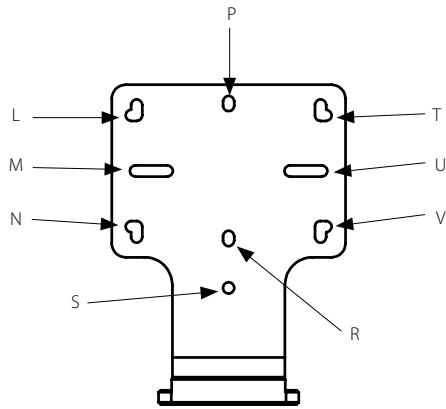

**Barcode Scanner Holder**

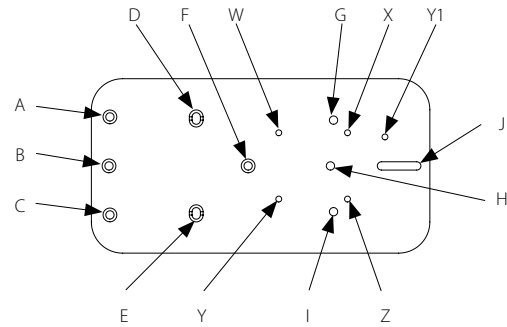

**Secondary Extension Plate**

Brand	Model	Dock	Placement	Hole #
Zebra	Ultra-Rugged Barcode Scanners XX3678 Cordless Scanners STB3678 Industrial Scanner Cradle	Ultra-Rugged Barcode Scanners XX3678 Cordless Scanners STB3678 Industrial Scanner Cradle	Secondary Extension Plate (X-BRCDHLD-PLT)	D, E, J
Zebra	Ultra-Rugged Barcode Scanners XX3678 Cordless Scanners FLB3678 Industrial Scanner Cradle	Ultra-Rugged Barcode Scanners XX3678 Cordless Scanners FLB3678 Industrial Scanner Cradle	Secondary Extension Plate (X-BRCDHLD-PLT)	D, E, J
Zebra	Healthcare Barcode Scanners DS8100-HC DS8178 Cordless Digital Scanner CR 8178-PC Presentation Cradle Charging Base	Healthcare Barcode Scanners DS8100-HCDS8178 Cordless Digital Scanner CR 8178-PC Presentation Cradle Charging Base	Secondary Extension Plate (X-BRCDHLD-PLT)	H, J
Zebra	Healthcare Barcode Scanners DS8100-HC DS8178 Cordless Digital Scanner CR 8178-SC Standard Cradle	Healthcare Barcode Scanners DS8100-HC DS8178 Cordless Digital Scanner CR 8178-SC Standard Cradle	Secondary Extension Plate (X-BRCDHLD-PLT)	H, J
Zebra	Healthcare Barcode Scanners Fixed Mount Scanner Series Support DS457 Series	Healthcare Barcode Scanners Fixed Mount Scanner Series Support DS457 Series	Barcode Scanner Holder (X-BRCDHLD-LBKT)	M, R
Zebra	MiniScan MS954	MiniScan MS954	Barcode Scanner Holder (X-BRCDHLD-LBKT)	M, R
Datalogic	QUICKSCAN 2400 2131 Series Multi Purpose Holder Mounting	QuickScan 2400 2131 Series Multi Purpose Holder Mounting	Secondary Extension Plate (X-BRCDHLD-PLT)	F, J
Datalogic	Datalogic Handheld Scanner General Duty Gryphon 4200 Series WLC4190 Wireless Charging Base Station Mounting Adapter	Datalogic Handheld Scanner General Duty Gryphon 4200 Series WLC4190 Wireless Charging Base Station Mounting Adapter	Secondary Extension Plate (X-BRCDHLD-PLT)	H, J

## Section 3: Device Installation

Brand	Model	Dock	Placement	Hole #
Datalogic	DATALOGIC GRYPHON GBT4500-HC (CHARGING BASE MODEL #: WLC4090)	Datalogic Gryphon GBT4500-HC Charging Base Model #: WLC4090	Secondary Extension Plate (X-BRCDHLD-PLT)	W, X, Y, Z
Datalogic	Datalogic Handheld Scanner General Duty Heron Family Stand	Datalogic Handheld Scanner General Duty Heron Family Stand	Barcode Scanner Holder (X-BRCDHLD-LBKT)	M, V
Datalogic	Datalogic Handhelds Scanner General Duty Heron Family AutoSense Flex Stand	Datalogic Handhelds Scanner General Duty Heron Family AutoSense Flex Stand	Barcode Scanner Holder (X-BRCDHLD-LBKT)	M, V
Datalogic	Datalogic Fixed Retail Scanner Single Plane Scanner Magellan 34XXVSi Cradle	Datalogic Fixed Retail Scanner Single Plane Scanner Magellan 34XXVSi Cradle	Barcode Scanner Holder (X-BRCDHLD-LBKT)	M, U
Datalogic	Datalogic Fixed Retail Scanner Single Plane Scanner Magellan 3450VSi Magellan 3410VSi TILT RISER	Datalogic Fixed Retail Scanner Single Plane Scanner Magellan 3450VSi Magellan 3410VSi TILT RISER	Barcode Scanner Holder (X-BRCDHLD-LBKT)	M, U
Datalogic	Datalogic Fixed Retail Scanner Presentation Scanner Gryphon GPS 4400 2D Stand	Datalogic Fixed Retail Scanner Presentation Scanner Gryphon GPS 4400 2D Stand	Barcode Scanner Holder (X-BRCDHLD-LBKT)	L, M
Honeywell	Barcode Scanner General Purpose Handheld XENON XP 195X Series CCB-H-010-BT/CCB-H-010BT-BF Charging Base	Barcode Scanner Rugged Handheld Granit XP 199xi Series CCB22-100BT-03N/COB22 Charging Base	Secondary Extension Plate (X-BRCDHLD-PLT)	B, F
Honeywell	Barcode Scanner Rugged Handheld GRANIT XP 199xi Series CCB22-100BT-03N/COB22 Charging Base	Barcode Scanner Rugged Handheld Granit XP 199xi Series COB02 Charging Base	Secondary Extension Plate (X-BRCDHLD-PLT)	A, C, H
Honeywell	Barcode Scanner Rugged Handheld GRANIT XP 199xi Series COB02 Charging Base	Barcode Scanner Rugged Handheld Granit XP 199xi Series COB02 Charging Base	Secondary Extension Plate (X-BRCDHLD-PLT)	A, C, H
Code	CODE CR2700 (CHARGING BASE MODEL #: CRA-A271)	Code CR2700 Charging Base Model #: CRA-A271	Secondary Extension Plate (X-BRCDHLD-PLT)	Y, Y1

# Section 4: Installation on Mounting Platform

## Mounting Preparation

**⚠ WARNING:** DO NOT MOUNT THE *BARCODE SCANNER HOLDER* ANYWHERE NEAR OR ABOVE A PATIENT'S HEAD.

## Mounting on the MRS

**⚠ WARNING:** TO PREVENT THE *MOUNTING ADAPTER* FROM SLIDING DOWN RAIL, ENSURE THE TWO SCREWS ARE FASTENED TO THE TIGHTEST POSSIBLE POSITION. SERIOUS INJURIES CAN RESULT IF SCREWS ARE IMPROPERLY FASTENED.

**⚠ WARNING:** ENSURE RAIL IS STABLE AND PROPERLY INSTALLED BEFORE MOUNTING *BARCODE SCANNER HOLDER*.

**i NOTE:** The *MONITOR BRACKET STOPPER (TOP)* and the *MONITOR BRACKET STOPPER (BOTTOM)* are there to prevent the *MOUNTING ADAPTER* from sliding out of the rail. The *MOUNTING ADAPTER* must be taken out of the top of the MRS with the *MONITOR BRACKET STOPPER (TOP)* pressed back into the MRS.

**i NOTE:** The image below shows the *MOUNTING ADAPTER* without the *BARCODE SCANNER HOLDER*. This is only for clarity.

## Instructions

1. Lift up the barcode scanner and mounted base, and guide the *MOUNTING ADAPTER* into the top of the MRS rail as shown (**Figure 1**).
2. Once the base is at the desired height on the MRS rail, tighten 2 x *BLACK SET SCREWS* to the tightest possible position on the *MOUNTING ADAPTER* using a 1/8" hex key.

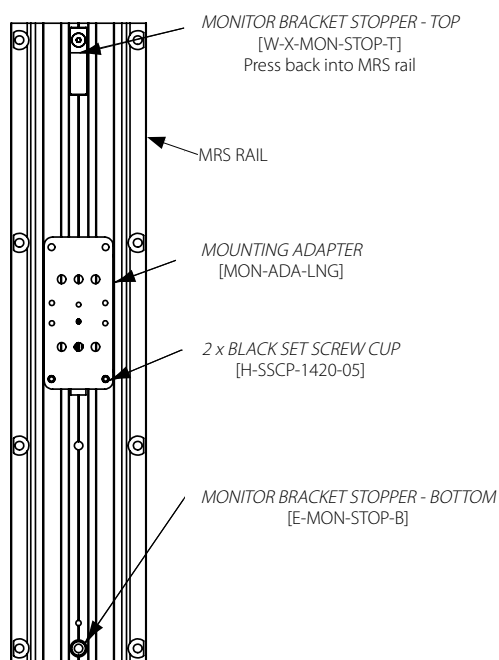

**NOTE:** Length of MRS shown is for representational use only

# Section 4: Installation on Mounting Platform

## Mounting on the VRS/Dovetail/Ohmeda Rail

**WARNING:** ALL VERTICAL ADAPTERS MUST BE SITTING IN THE RAIL SECURELY OR SERIOUS INJURIES CAN RESULT.

**WARNING:** TO PREVENT THE *VERTICAL ADAPTER* OR *OHMEDA ADAPTER* FROM FALLING DOWN THE RAIL, ENSURE THAT THE *VERTICAL TRACK ADAPTER LOCK KNOBS* ARE FASTENED TO THE TIGHTEST POSSIBLE POSITION.

**WARNING:** ENSURE RAIL IS STABLE AND PROPERLY INSTALLED BEFORE MOUNTING BARCODE SCANNER HOLDER.

**WARNING:** THE MOUNTING ADAPTER FOR OHMEDA RAILS DIFFERS FROM THE MOUNTING ADAPTERS OR VRS. THE ADAPTERS ARE NOT CROSS-COMPATIBLE BUT SHARE THE SAME MOUNTING TECHNIQUE. ONLY THE VRS ADAPTER IS SHOWN BELOW.

**NOTE:** When the *VERTICAL ADAPTER LOCK KNOB* is turned clockwise, it causes the lock of the adapter to slide inward locking the adapter onto the rail. When it is turned counter-clockwise, it causes the adapter to slide outward, unlocking the adapter.

### Instructions

1. Ensure the *VERTICAL ADAPTER LOCK KNOB* is fully loosened. Angle the adapter from the left of the VRS/OHMEDA rail and rotate the adapters into the groove of the rail.
2. Tighten the *VERTICAL ADAPTER LOCK KNOB* when adapter is at the desired height. Ensure it is completely tightened.

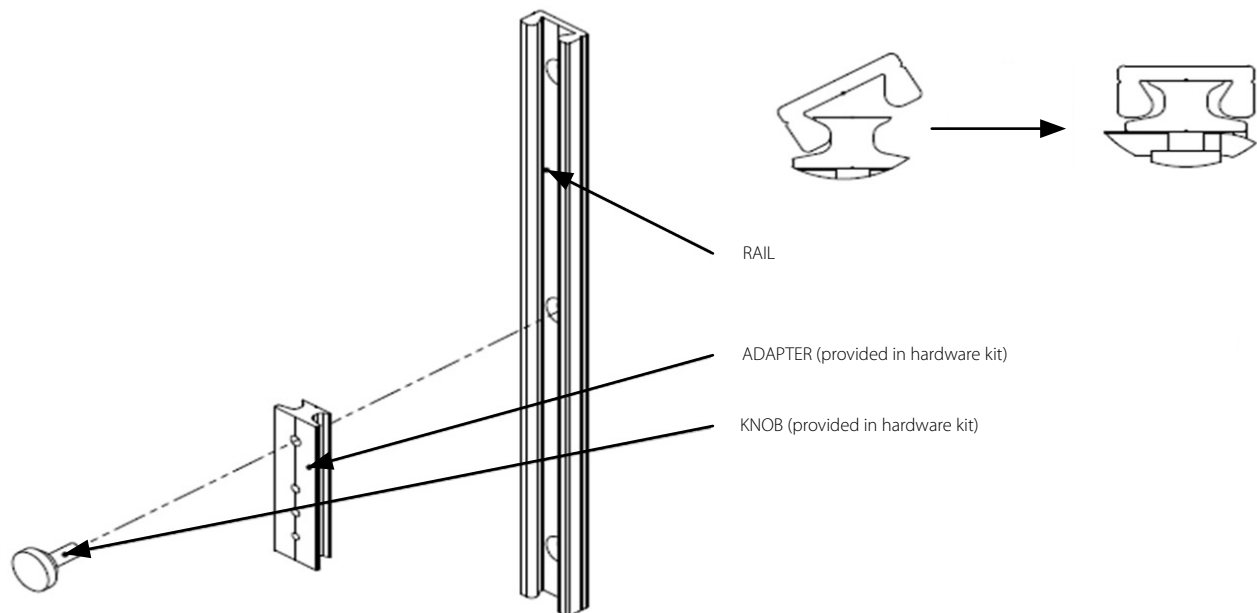

# Section 4: Installation on Mounting Platform

## Mounting on ARS

**⚠ WARNING:** AFTER THE MOUNTING ADAPTERS ARE INSTALLED, ENSURE THAT THE LEVERS ON THE MOUNTING ADAPTERS ARE PRESSED IN AS FAR AS POSSIBLE AND THE ADAPTERS ARE PLACED CORRECTLY INSIDE THE RAIL BEFORE MOUNTING DEVICES.

**⚠ WARNING:** ENSURE RAIL IS STABLE AND PROPERLY INSTALLED BEFORE MOUNTING BARCODE SCANNER HOLDER.

## Instructions

1. Install the BARCODE SCANNER HOLDER onto rail by angling the upper lip into the inside lip of the ARS (**Figure 1**), pull the *LEVER ARM* back against the *HORIZONTAL TRACK ADAPTER* and push into the rail. Once secured, release the *LEVER ARM* (**Figure 2**).

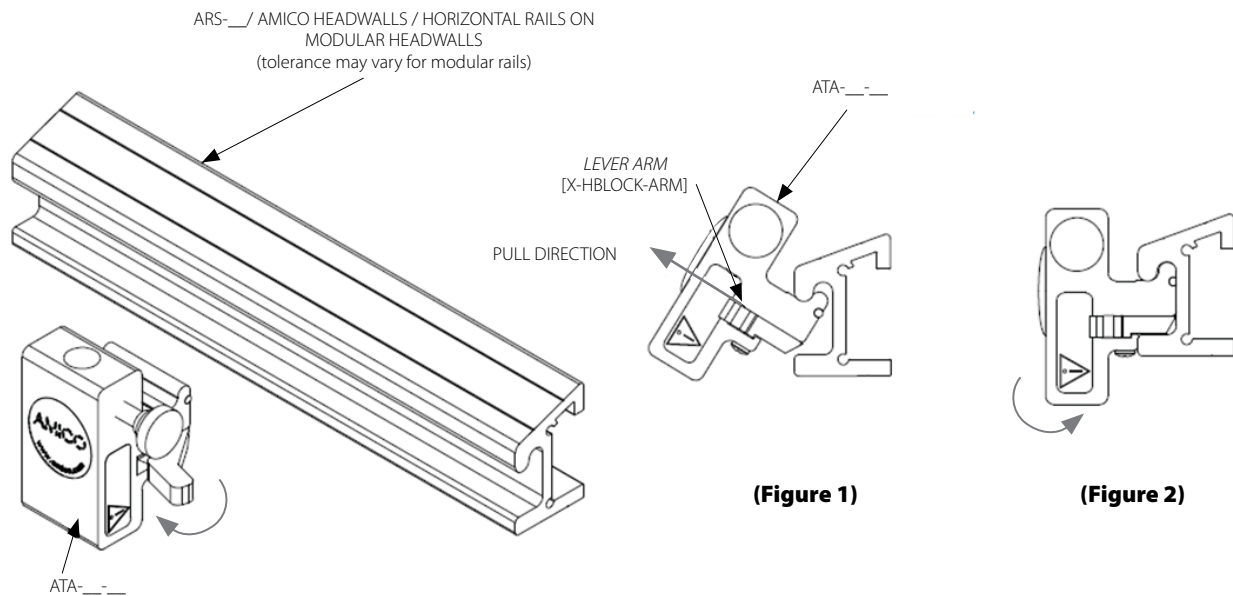

# Section 4: Installation on Mounting Platform

## Mounting on FRS and LRS

**⚠ WARNING:** DO NOT ATTEMPT TO MOUNT/REMOVE FROM THE RAIL WHEN LOADED.

**⚠ WARNING:** DO NOT MOUNT SYSTEM ANYWHERE NEAR OR ABOVE A PATIENT'S HEAD.

**⚠ WARNING:** ENSURE RAIL IS STABLE AND PROPERLY INSTALLED BEFORE MOUNTING.

**i NOTE:** The FRS and the LRS use the same *FAIRFIELD TRACK ADAPTER*. The installation procedure is the same for both adapters. Only the FAIRFIELD configuration is shown below.

### Instructions

1. Unscrew 2 x *ALLOY HEX SOCK SET SCREWS*. Do not unscrew all the way, only until the top of the bearings are flush with the adapter surface. Ensure the groove on the adapter sits in the groove on the rail.
2. Completely tighten the bearings and ensure the bearings sit on the bottom groove of the FRS rail.

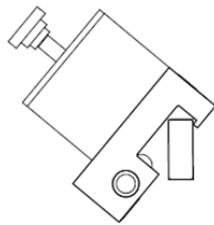

**(Figure 1)**

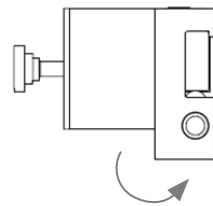

**(Figure 2)**

# Section 4: Installation on Mounting Platform

## Mounting on DIN Rail

**i NOTE:** The *DIN RAIL ADAPTER* does not have grooves on it and the push button permits clamping around the rail's cross section.

### Instructions

1. Engage push button until the tops of the 2 x *NYLON BALL BEARINGS* are flush with the adapter surface. Push the *BARCODE SCANNER HOLDER* towards the rail (as shown by the arrow) and ensure the adapter sits in the groove on the rail.
2. Release push button and ensure the bearings sit on the bottom groove of the DIN rail.

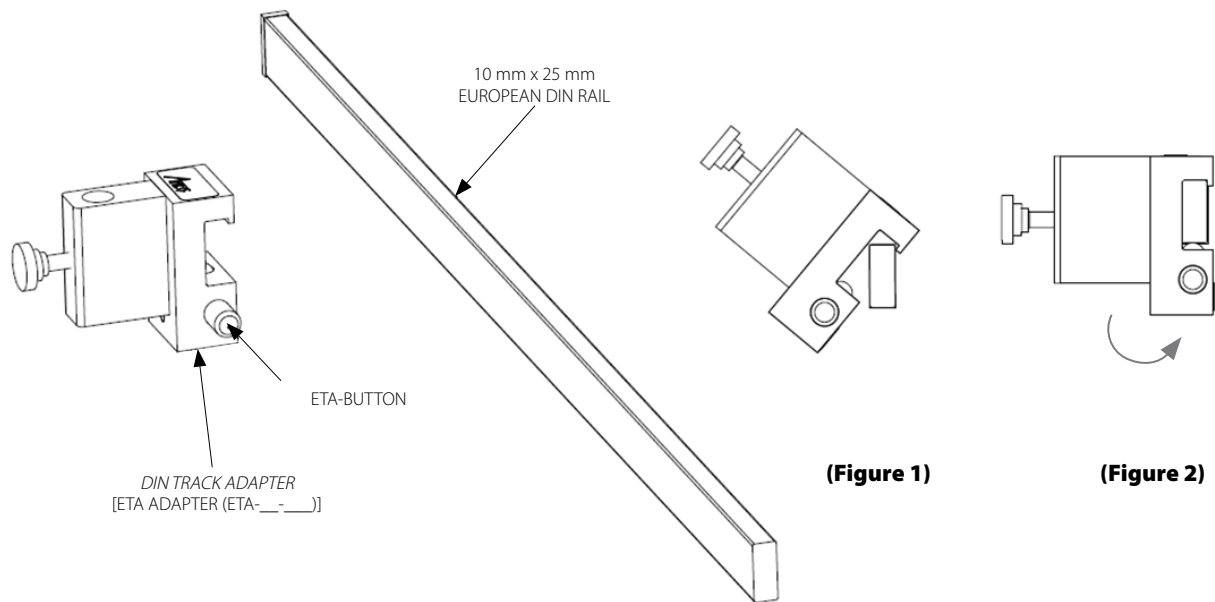



# Section 4: Installation on Mounting Platform

## Mounting on Hill-Rom/HSI Rail Systems

**⚠ WARNING:** TO PREVENT THE *MOUNTING ADAPTER* FROM FALLING DOWN THE CHANNEL, ENSURE THAT THE *KNOBS* ARE SECURED TO THE TIGHTEST POSSIBLE POSITION.

**⚠ WARNING:** ENSURE RAIL IS STABLE AND PROPERLY INSTALLED BEFORE MOUNTING.

**ℹ NOTE:** The HSI Rail system uses the *HSI TRACK ADAPTERS* instead of the *HILL-ROM TRACK ADAPTERS*. The mounting techniques for both adapter types are the same. ONLY the HILL-ROM vertical rail configuration is shown below.

### Instructions

1. Rotate the *HILL-ROM RAIL ADAPTER PIN* counter clockwise in order to loosen.
2. Slide the *HILL-ROM TRACK ADAPTERS* down the Hill-Rom rail channel towards the desired height. Ensure both *HILL-ROM TRACK ADAPTERS* are in the rail. Once in, rotate the *ADAPTER KNOB* clockwise to tighten the *HILL-ROM RAIL ADAPTERS* onto the rail. Ensure the knobs are completely tightened and the *BARCODE SCANNER HOLDER* is secure on the rail.

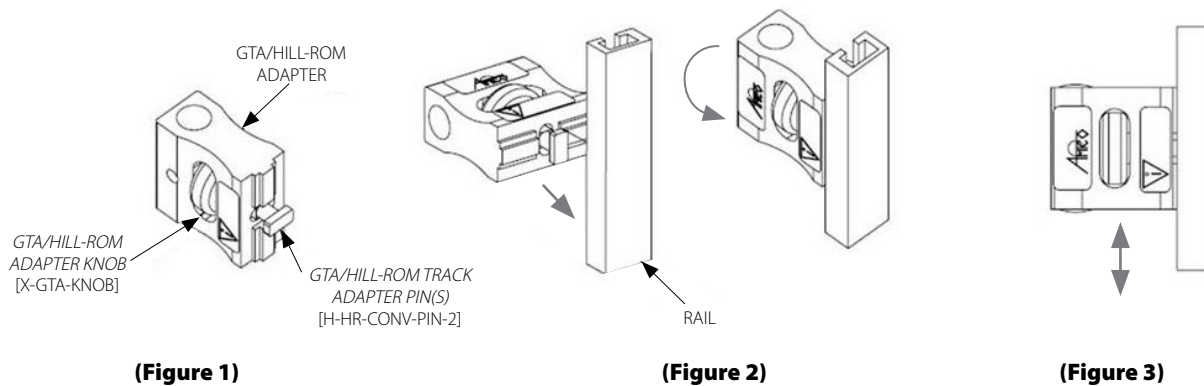

# Section 4: Installation on Mounting Platform

## Mounting on 1.25" Diameter Post

**⚠ WARNING:** DO NOT MOUNT ON POST ABOVE PATIENT'S HEAD. ENSURE POST IS STABLE AND PROPERLY INSTALLED BEFORE MOUNTING.

### Instructions:

1. Align POLE CLAMP FRONT HALF perpendicular to the axis of the post at the desired height as shown below.
2. Align the holes of POLE CLAMP BACK HALF and POLE CLAMP FRONT HALF with the post between.
3. Insert 2 x HEX SOCKET CAP SCREW through POLE CLAMP BACK HALF and tighten it into POLE CLAMP FRONT HALF.

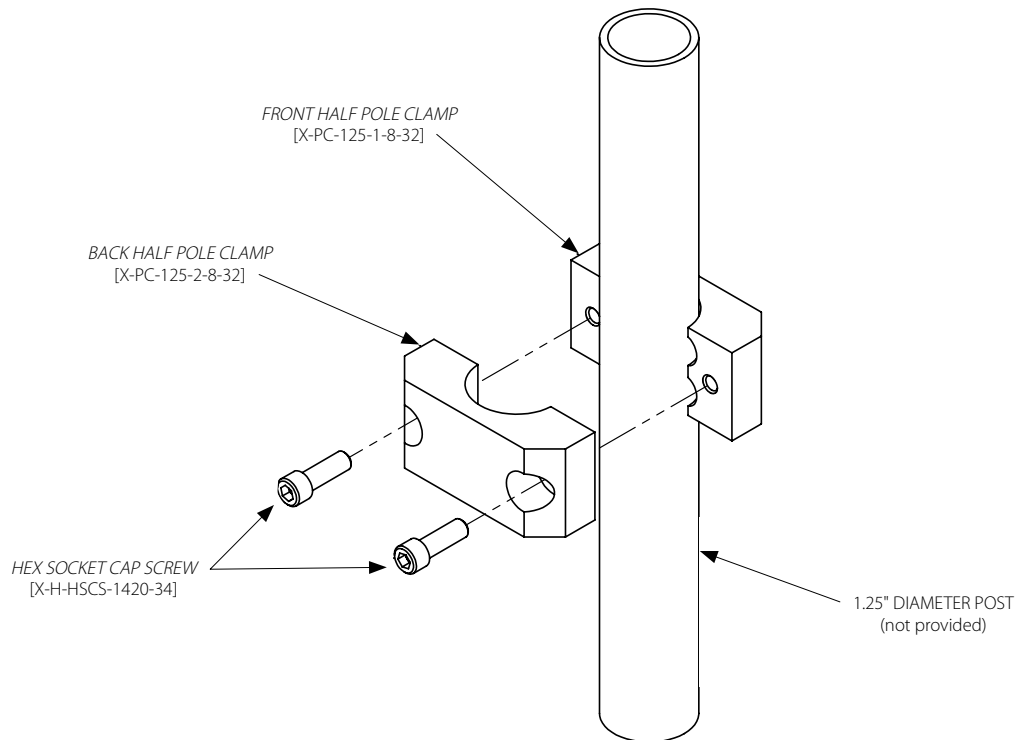

# Section 4: Installation on Mounting Platform

## Mounting to LCD

**i NOTE:** This BARCDHLD2-LCD configuration weighs 4 lbs. Ensure that the combined weight of BARCDHLD2-LCD, the monitor, and the barcode scanner mounted onto BARCDHLD2-LCD are within the weight limit of the mounting platform.

### Instructions

1. Slide *LCD SHELF ARM* to desired position and tighten 2 x *HEX NUT*. Insert and tighten 2 x *NYLON LOCK NUT* to lock *LCD SHELF ARM* in place as seen below. Cover the exposed nuts with 2 x *HEX BOLT NUT AND CAP*.
2. Loosely insert 2 x 16 mm *PAN HEAD SCREW* through the top of two holes of *MONITOR HANDLE BODY* and into monitor (not provided) as seen below. If the mounting pattern is recessed in the monitor, place 4 x *NYLON STANDOFF* between *MONITOR HANDLE BODY* and the monitor, and use 20 mm *MACHINE SCREWS* instead of 16 mm *PAN HEAD SCREW*.
3. Slide 2 x 12 mm *PAN HEAD SCREW* into the U-notches on the LCD VESA plate (not provided). Insert another 2 x 12 mm *PAN HEAD SCREW* into 2 bottom holes of the LCD VESA plate, *MONITOR HANDLE BODY* and into monitor as seen below.
4. Tighten 4 x 12 mm *PAN HEAD SCREW* in a cross-pattern.

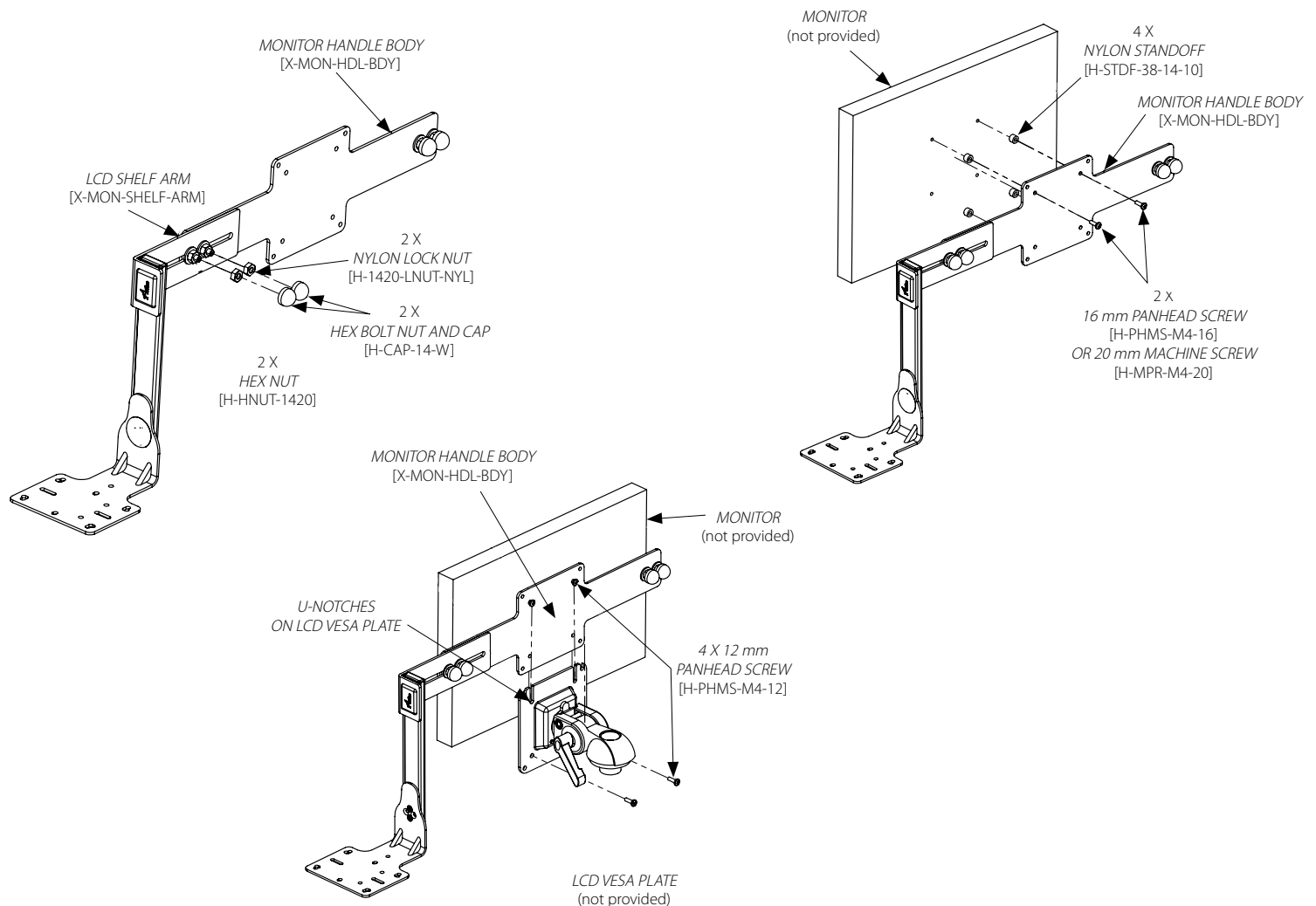

## Section 5: Adjustments (LCD)

**i NOTE:** Ensure Pre-Installation and Installation to Device instructions have been performed.

### Instructions

1. To adjust BARCDHLD2-LCD, remove 2 x *HEX BOLT NUT AND CAP*, 2 x *NYLON LOCK NUT* and loosen 2 x *HEX NUT*.
2. Slide LCD SHELF ARM to desired location and re-tighten 2 x *HEX NUT* and 2 x *NYLON LOCK NUT*.

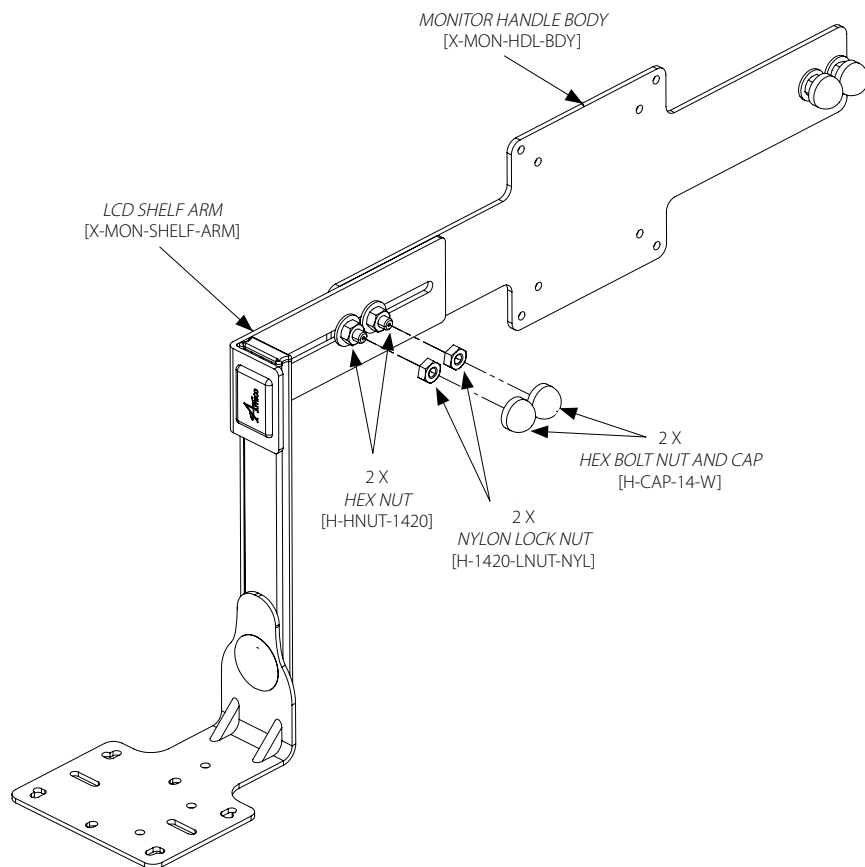

# Section 6: Maintenance and Troubleshooting

## Troubleshooting Guide

Symptoms	Possible Cause	Solution
Scanner base appears tilted/not centered	Loose mounting configuration or device has shifted	Re-center mounting brackets and refer to instructions (Pre-Installation and Installation to Device).
Mounting bracket is shifting	Improper installation to mounting platform	Ensure device is secured to rail or mounting platform. Refer to instructions (Installation to Mounting Platform).

## Preventative Maintenance

 **WARNING:** THE INTERVALS SHOWN AS RECOMMENDED. MAINTENANCE SCHEDULES SHOULD BE MORE FREQUENT FOR HIGHER USE AREAS.

It is recommend that once **every one (1) month**, all locks, bolts, and screws are visually inspected for signs of product wear and tear or damage. Check the product for looseness in the mount or orientation, and ensure the adapter is secured to the rail or wall channel system.

## Section 7: Cleaning

 **WARNING:** THE CLEANING CHEMICALS AND METHODS BELOW ARE NOT MEANT FOR CONTROLLING ANY INFECTIONS. IT SHALL BE THE RESPONSIBILITY OF THE HOSPITAL OR THE HOSPITAL'S INFECTION CONTROL OFFICER TO SANITIZE THE EQUIPMENT.

 **WARNING:** PLEASE DO NOT SPRAY ANY CHEMICAL DIRECTLY ONTO THE BARCODE SCANNER HOLDER. APPLY ONTO A SOFT CLOTH AND WIPE CLEAN TO PREVENT CHEMICALS GETTING INTO THE INTERNAL COMPONENTS OF THE BARCODE SCANNER HOLDER.

The mounting assembly may be cleaned with most mild, non-abrasive solutions commonly used in the hospital environment (e.g. diluted bleach, ammonia, or alcohol solutions). The surface finish will be permanently damaged by strong chemical and solvent such as acetone and trichloroethylene. Steel wool or other abrasive material should never be used. Damaged caused by the use of unapproved substances or processes will not be warranted. It is recommended that you test any cleaning solution on a small area of the BARCODE SCANNER HOLDER that is not visible to verify compatibility. Never submerge the BARCODE SCANNER HOLDER and do not allow liquids to enter it. Wipe any cleaning agents off the BARCODE SCANNER HOLDER immediately using a water-dampened cloth. Dry the BARCODE SCANNER HOLDER thoroughly after.

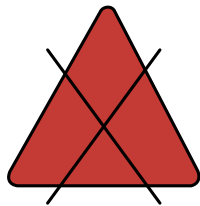

Acetone

**(Figure 1)**

### **No Acetone**

Acetone is a colorless, mobile, flammable liquid

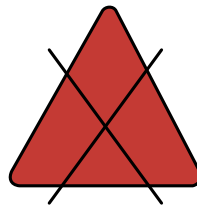

Trichloroethylene

**(Figure 2)**

### **No Trichloroethylene**

Trichloroethylene is a chlorinated hydrocarbon commonly used as an industrial solvent



## Warranty Policy - Equipment Mounting Solutions

Amico Accessories Inc. warrants all mounting accessories to be free from defects in material and workmanship for a period of twelve (12) months from the date of shipment. Within this period Amico Accessories Inc. will repair or replace any part which is proven to be defective.

Amico Accessories Inc. will warrant its materials to be free from defect for an additional period of four (4) years, (five [5] years from the date of shipment). Within this period, Amico Accessories Inc. will replace any part which is proven to be defective, at no charge. Shipping and Installation costs after the first twelve (12) months will be borne by the Customer.

This warranty is valid only when the product has been properly installed according to Amico Accessories Inc. specifications, used in a normal manner and serviced according to factory recommendations. It does not cover products that are not manufactured by Amico Accessories Inc. It does not cover failures due to damage which occurs in shipments or failures which result from accidents, misuse, abuse, neglect, mishandling, alteration, misapplication or damage that may be attributable to acts of God.

Amico Accessories Inc. shall not be liable for incidental or consequential damages resulting from use of equipment.

All claims for warranty must first be approved by Amico Accessories Inc. A valid Return Goods Authorization (RGA) number must be obtained from Amico Accessories Inc. prior to commencement of any service work. Warranty work, which has not been pre-authorized by Amico Accessories Inc., will not be reimbursed.

### **AMICO ACCESSORIES INC. DOES NOT HONOR VERBAL STATEMENTS CONCERNING THE WARRANTY.**

The distributor and/or dealer are not sanctioned to create verbal warranties about the product described in this agreement. Any statements will not be honored or be made part of the agreement of sale. This document is the final complete and exclusive terms of the agreement.

### **THIS WARRANTY IS INCLUSIVE AND REPLACES ALL OTHER WARRANTIES.**

Amico Accessories Inc. shall not, under any circumstances be liable for incidental or consequential damages including, but not limited to, profit, loss of sales or injuries to person(s) or property. Correction of noncompliance as noted above will result in completion of all liabilities of Amico Accessories Inc., whether based on agreement, neglect or changed materials, designs or specifications without notice.

All claims for warranty must first be approved by Amico Accessories Inc. Service Department: [accessories@amico.com](mailto:accessories@amico.com) or 1.877.264.2697. A valid Return Goods Authorization number must be obtained from Amico Accessories Inc. prior to commencement of any warranty claim.

[www.amico.com](http://www.amico.com)

Amico Accessories Inc. | 85 Fulton Way, Richmond Hill, ON L4B 2N4, Canada  
Toll Free Tel: 1.877.264.2697 | Tel: 905.763.7778 | Fax: 905.763.8587  
Email: [info@amico-accessories.com](mailto:info@amico-accessories.com) | [www.amico.com](http://www.amico.com)